

Data Protection Officer
Mid and East Antrim Borough Council
The Braid
1-29 Bridge Street
Ballymena
BT43 5EJ

Section B. Your Details

Q1. Are you responding as individual, as an organisation or as an agent acting on behalf of individual, group or organisation? (Required)

Please only tick one

- Individual (Please fill in the remaining questions in the section, then proceed to Section F.)
- Organisation (Please fill in the remaining questions in the section, then proceed to Section D.)
- Agent (Please fill in the remaining questions in the section, then proceed to Section E.)

Q2. What is your name?

Title

First Name (Required)

Last Name (Required)

Email

Q3. Did you respond to the previous Preferred Options Paper?

- Yes
- No
- Unsure

Section C. Individuals

Address Line 1 (Required)

Line 2

Line 3

Town (Required)

Postcode (Required)

Section D. Organisation

If you have selected that you are responding as an organisation, there are a number of details that we are legally required to obtain from you.

If you are responding on behalf of a group or organisation, please complete this section, then proceed to Section F.

Organisation / Group Name (Required)

Your Job Title / Position (Required)

Organisation / Group Address (if different from above)

Address Line 1 (Required)

Line 2

Line 3

Town (Required)

Postcode (Required)

Section E. Agents

If you have selected that you are responding on behalf of another individual, organisation or group there are a number of details that we are legally required to obtain from you.

Please provide details of the individual, organisation or group that you are representing.

Client Contact Details

Title

First Name **(Required)**

Last Name **(Required)**

Address Line 1 **(Required)**

Line 2

Line 3

Town **(Required)**

Postcode **(Required)**

Q4. Would you like us to contact you, your client or both in relation to this response or future consultations on the LDP?

Please only select one.

Agent Client Both

Section F. Soundness

The draft Plan Strategy will be examined at Independent Examination in regard to its soundness. Accordingly, your responses should be based on soundness and directed at specific strategic policies or proposals that you consider to be unsound, along with your reasons. The tests of soundness are set out below in Section M.

Those wishing to make representations seeking to change the draft Plan Strategy should clearly state why they consider the document to be **unsound** having regard to the **soundness tests** in Section M. It is very important that when you are submitting your representation that your response reflects the most appropriate soundness test(s) which you believe the draft Plan Strategy fails to meet. There will be no further opportunity to submit information once the consultation period has closed unless the Independent Examiner requests it.

Those who make a representation seeking to change the draft Plan Strategy should also state whether they wish to be heard orally.

Section J. Type of Procedure

Q5. Please indicate if you would like your representation to be dealt with by:

(Required)

Please select one item only

BOTH

Written (Choose this procedure to have your representation considered in written form only)

Oral Hearing (Choose this procedure to present your representation orally at the public hearing)

Unless you specifically request a hearing, the Independent Examiner will proceed on the basis that you are content to have your representation considered in written form only. Please note that the Independent Examiner will be expected to give the same careful consideration to written representations as to those representations dealt with by oral hearing.

Section K. Is the draft Plan Strategy Sound?

Your comments should be set out in full. This will assist the Independent Examiner understand the issues you raise. You will only be able to submit further additional information if the Independent Examiner invites you to do so.

Sound

If you consider the Plan Strategy to be Sound and wish to support the Plan Strategy, please set out your comments below.

(Required)

Section L. Unsound

In this section we will be asking you to specify which part(s) of the draft Plan Strategy you consider to be unsound.

Note: If you wish to inform us that more than one part of the draft Plan Strategy is unsound each part should be listed separately. Complete this page in relation to one part of the draft Plan Strategy only.

Q6. If you consider that the draft Plan Strategy is unsound and does not meet one or more of the tests of soundness below, you must indicate which test(s) you consider it does not meet, having regard to Development Plan Practice Note 6 available at:

https://www.planningni.gov.uk/index/news/dfi_planning_news/news_releases_2015_onwards/development_plan_practice_note_06_soundness_version_2_may_2017_.pdf

Please note if you do not identify a test(s) your comments may not be considered by the Independent Examiner.

Continued on next page.

Section M. Tests of Soundness (Required)

Procedural tests

- P1. Has the plan been prepared in accordance with the Council's timetable and the Statement of Community Involvement?
- P2. Has the Council prepared its Preferred Options Paper and taken into account any representations made?
- P3. Has the plan been subject to Sustainability Appraisal including Strategic Environmental Assessment?
- P4. Did the Council comply with the regulations on the form and content of its plan and on the procedure for preparing the plan?

Consistency tests

- C1. Did the Council take account of the Regional Development Strategy?
- C2. Did the Council take account of its Community Plan?
- C3. Did the Council take account of policy and guidance issued by the Department?

Coherence and effectiveness tests

- CE1. The plan sets out a coherent strategy from which its policies and allocations logically flow and where cross boundary issues are relevant is it in conflict with the plans of neighbouring Councils.
- CE2. The strategy, policies and allocations are realistic and appropriate having considered the relevant alternatives and are founded on a robust evidence base.
- CE3. There are clear mechanisms for implementation and monitoring.
- CE4. The plan is reasonably flexible to enable it to deal with changing circumstances.

Section N. Which part(s) of the draft Plan Strategy are you commenting on?

This should relate to only one section, paragraph or policy of the draft Plan Strategy. If you wish to inform us that you consider more than one part of the draft Plan Strategy is unsound, you can submit further representations by completing and submitting additional copies of this section.

Relevant Policy number(s) CS1 SUSTAINABLE DEV IN COURTSIDE

~~HOU8~~, HOU9 HOU12 HOU13

(and/or)

Relevant Paragraph number(s)

(and/or)

District Proposals Map

CARRICKFERGUS

Please give full details of why you consider the draft Plan Strategy to be unsound having regard to the tests(s) you have identified above. Please be as clear and concise as possible.

I CONSIDER THE PLAN UNSOUND DUE TO MY EXPERIENCE WITH THE PREVIOUS PLAN. MY ISSUE IS WITH 2 PLOTS I PURCHASED 23 YEARS AGO AND HAD THEM IN THE PREVIOUS DRAFT STRATEGY BUT FOR SOME UNKNOWN REASON THEY WERE EXCLUDED FROM THE FINAL STRATEGY. THIS COULD NOT EVEN BE EXPLAINED BY THE PLANNING OFFICE.

THE LAND IN QUESTION IS 94 BELFAST ROAD IN THE TOWNSHIP OF KNOCKNAGULLIAG REF 93640 AND 93641. FILIO ATTACHED.

I AM CITING ① (HOU19) REPLACEMENT OF DWELLING IN ACCORDANCE TO HOU19. THERE WERE 2 DWELLINGS ON MY PLOTS 25 YEARS AGO, JUST BEFORE I PURCHASED, ONE BURNT IN 1994 THE OTHER WAS DIRECT. ② (HOU12) SITED WITHIN AN EXISTING CLUSTER IN ACCORDANCE TO (HOU12).

MY SITES ARE AT THE END OF A CLUSTER OF PROPERTIES, SOME OF WHICH HAVE DEVELOPED AND SOME NEW BUILDS OF LATE. MY SITES WOULD END THE DEVELOPMENT

If you consider the draft Plan Strategy to be unsound, please provide details of what changes(s) you consider necessary to make the draft Plan Strategy sound.

TIDY THE DEVELOPMENT AND HAVE FULL SUPPORT OF ALL RESIDENTS. SITE ALSO HAS BEEN USED TO FLY TIP AND THIS WOULD END WITH DEVELOPMENT

HOU13.. DEVELOPMENT OF A SMALL GAP SITE & CONTINUOUSLY BUILT UP FRONTAGE IN ACCORDANCE WITH (HOU13)

MY SITE IS ON THE ROAD FRONTAGE AND WOULD COMPLETE THE SETTLEMENT. SEVERAL SITES AT EACH END OF SETTLEMENT HAVE BEEN DEVELOPED AND NEW BUILDS ERECTED

THE FACT THAT THE ABOVE ISSUES HAVE NOT BEEN ADDRESSED LEAVES ME TO SEE THE DRAFT AS UNSOUND.

IF ANY DRAFT PLAN COMES FORWARD I WOULD LIKE TO SEE FOLIOS 25437 & 22658 INCLUDED.

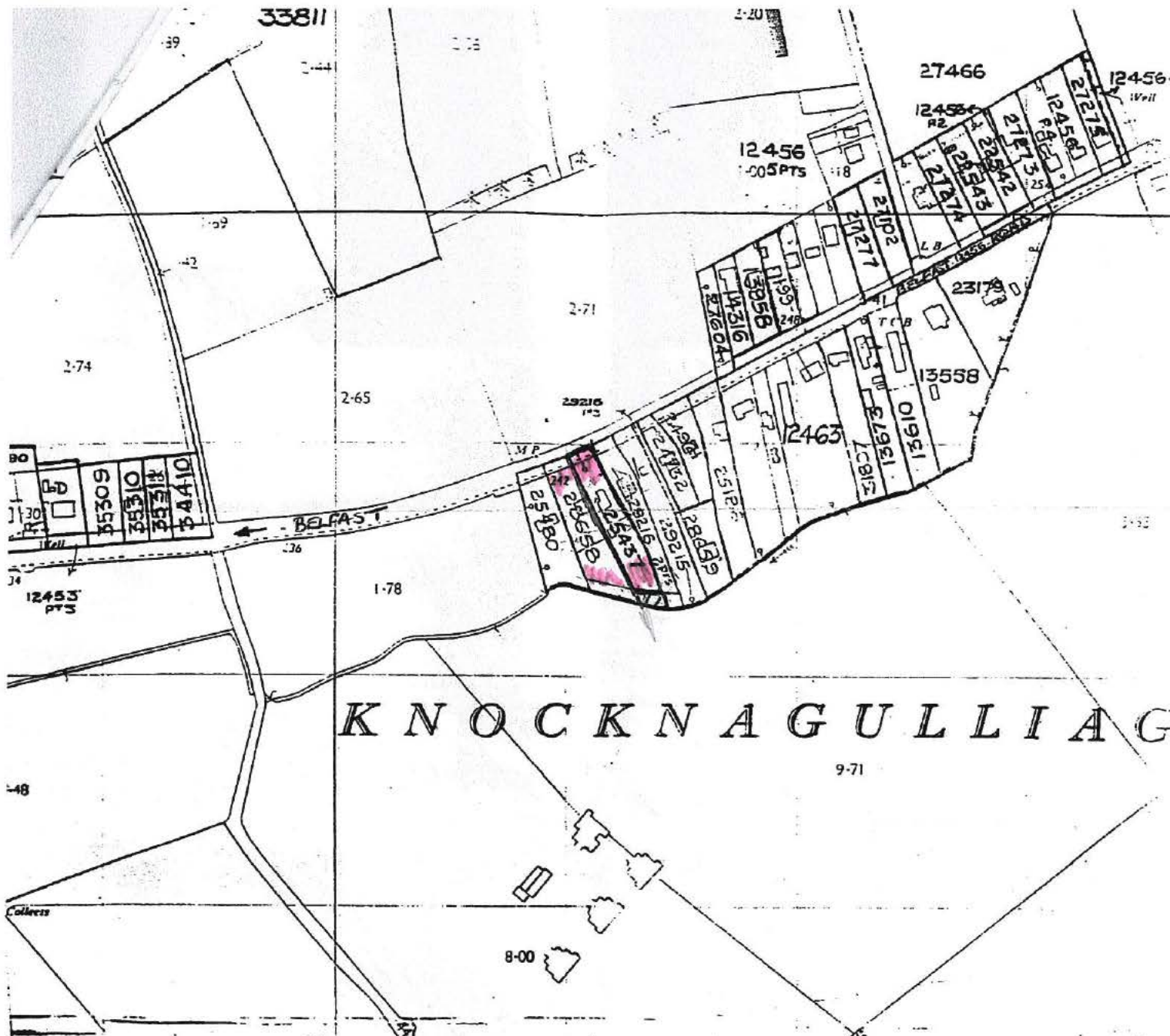

KNOCKNAGULLIA

LAND REGISTRY OF NORTHERN IRELAND

YOUR REF . [REDACTED]

OUR REF NI 93640

COUNTY ANTRIM

FOLIO 25437

O.S. MAP 1:50,000

SCALE 1:500

PREPARED BY

DATE 1982

The above is an uncertified photographic extract from the Land Registry map. The Folio(s) noted is/are outlined in red.

Caution

1. This extract does not include any dealing or cancellations pending at the date of issue.
2. Map entries are not reproduced in colour. A certified copy showing incumbrances (if any) in colour is available on payment of the appropriate fee (see Land Registry Fees) Letter NI 1982 No 26).

3351

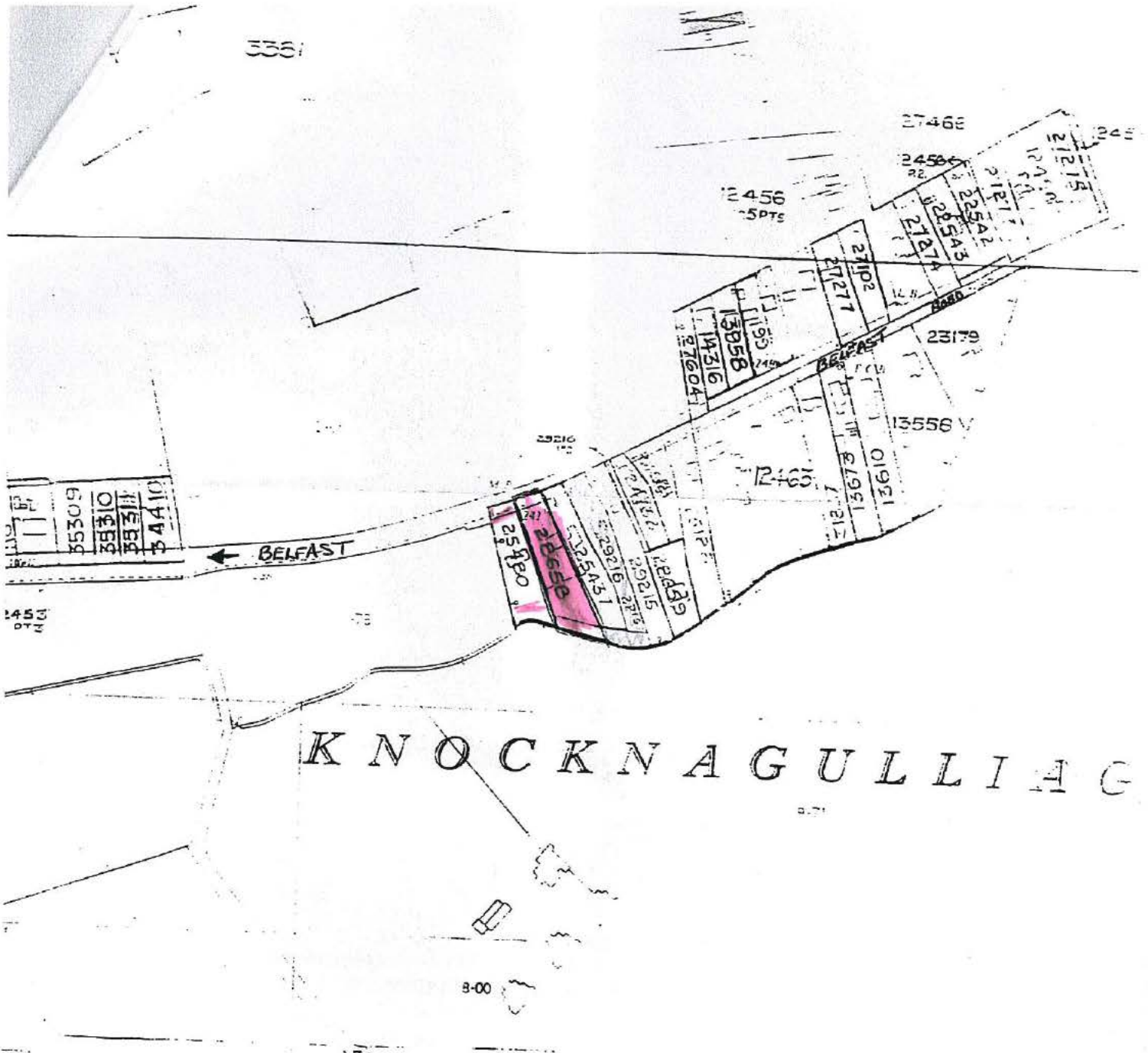

KNOCKNAGULLIAC

LAND REGISTRY OF NORTHERN IRELAND

YOUR REF [REDACTED]
 OUR REF NO 93641
 COUNTY ANTRIM
 FOLIO 2865B
 I.C. MAP 1:25,000
 SCALE 1:500
 PREPARED BY
 DATE 1958

The above is an uncertified photographic extract from the Land Registry map. The Folios noted is/are outlined in red.

Caution

1. This extract does not include any leasing or cancellations pending at the date of issue.
2. Map entries are not reproduced in colour. A certified copy showing incumbrances, if any in colour is available on payment of the appropriate fee see Land Registry Fees Book No. 1001 of 1958.